

## SuperWire F

Designed by Formafantasma, 2024

56W - 4134lm - 2700K - CRI> 90



SuperWire is the first family of modular lamps designed by Formafantasma for Flos. A magical and poetic project, with an essential design but a great stage presence, which recalls the work of the great glass masters of the last century. Made of planar glass and polished aluminum, its design originated from the development of a custom-made light source that emits a warm and homogeneous light. Made up of one or more hexagons of planar glass connected by a polished aluminum element, SuperWire lights up its entire surface thanks to a new source: a very thin, flat, soft, flexible LED strip measuring up to one meter, which emits a warm and homogeneous light along its entire length and which can be easily removed for replacement and repair, unique in the panorama of LED bulb-less lamps. This floor version, is built with two 75 cm high modules, placed one above the other, resting on a steel tripod, a tribute to the historic Luminator by the Castiglioni brothers.

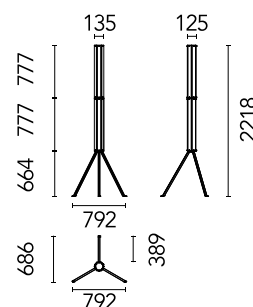

Are you a professional and your project needs consulting and support?

[BOOK AN APPOINTMENT](#)

### Main specifications

EAN	8059607068304
Mounting	Floor
Environments	Indoor dry location
Light source type	LED
Light sources included	Yes
LED type	Filament LED
Power (W)	56
System power (W)	56
Lumen Output (lm)	4134

### Physical

Colour	Steel
Length (mm)	792
Cord colour	Clear
Cord length (mm)	3000
Net weight (kg)	12
Package volume (m3)	0.14
IP internal	20

### Download

Mounting instructions

[↓ PDF](#)

### Photometric Files

ULD

[↓ ULD](#)

LDT / IES

[↓ ZIP](#)

### Technical Drawings

2D

[↓ ZIP](#)

3D

[↓ ZIP](#)

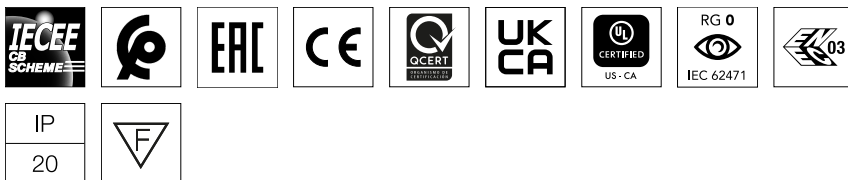

Schematic light drawing

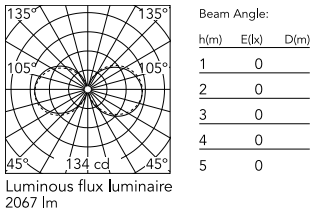

Photometric

Lighting type	Total
Light distribution	Asymmetric
CCT (K)	2700
CRI>	90
Extreme cut off	No

Electrical

Insulation class	III
Frequency (Hz)	50/60
Main voltage (Vac)	100-240
Power supply	Remote included
Dimmable	Yes
Power supply type	Dimmable
Dimming interface	Dimmer Integrated
Plug type	Type G, Type A, Type C
Batteries inside	No

Ecodesign and Energy Labelling

This product contains a light source of energy efficiency class E

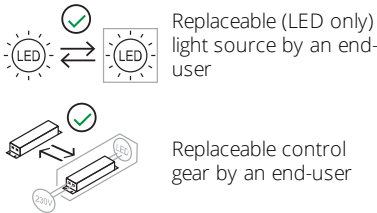

Spare Parts

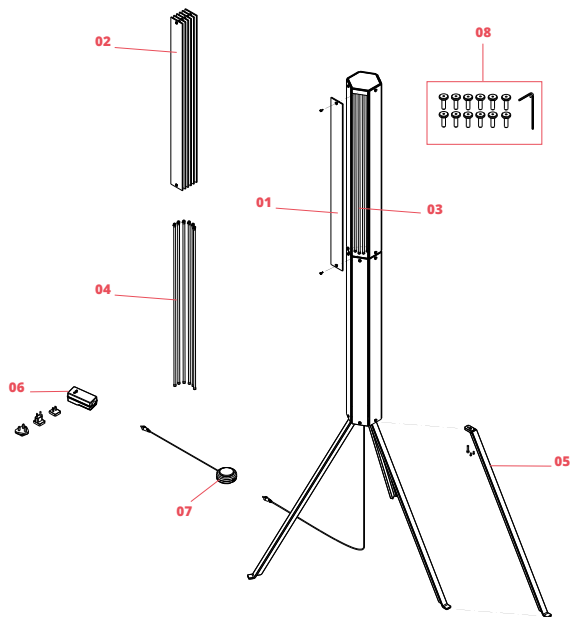

01.	Superwire Floor long glass plate and bushings	RF301F200
02.	Superwire Floor long glass plates and bushings kit 6 pcs	RF301F300
03.	Superwire Floor Led L750 L750 40MA/42VDC/27K filament	RF301F400
04.	Superwire Floor Led L750 L750 40MA/42VDC/27K filament kit 6 pcs	RF301F500
05.	Superwire Floor Brill leg assembly	RF301F164
06.	Black plug assembly kit & 48V driver	RF6600130
07.	Superwire Floor Switch dimmer assembly 48V	RF37195
08.	Superwire Kit with special screws	RF301T100



RF301F200  
Superwire Floor long glass plate  
and bushings



RF301F300  
Superwire Floor long glass plates  
and bushings kit 6 pcs



RF301F400  
Superwire Floor Led L750 L750  
40MA/42VDC/27K filament



RF301F500  
Superwire Floor Led L750 L750  
40MA/42VDC/27K filament kit 6  
pcs



RF301F164  
Superwire Floor Brill leg assembly



RF6600130  
Black plug assembly kit & 48V  
driver



RF37195  
Superwire Floor Switch dimmer  
assembly 48V



RF301T100  
Superwire Kit with special screws